



**ICETRO**  
**America**

## WU-0100-AC

### Features

- Stainless Steel Exterior - Durable & Rust resistant
- Up to 105 lbs of ice production per 24 hrs
- 27 lbs of Ice storage
- Control board diagnostics
- High density urethane foam insulation
- Improved Freezing Surface Technology
- Easy exchange front load built-in water filters
- Adjustable Stainless Steel Legs
- Compact design

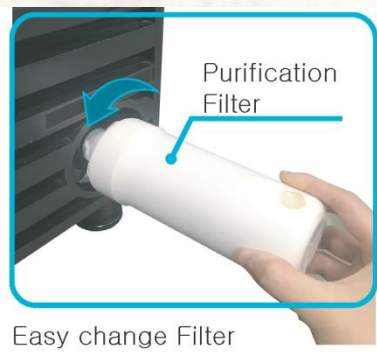

### WARRANTY

Ice Maker - Three Years Parts and Labor

Evaporator and Compressor - Five years Parts and Three Years Labor



WU-0100 UNDERCOUNTER ICE MAKER



**ICETRO**  
**America**

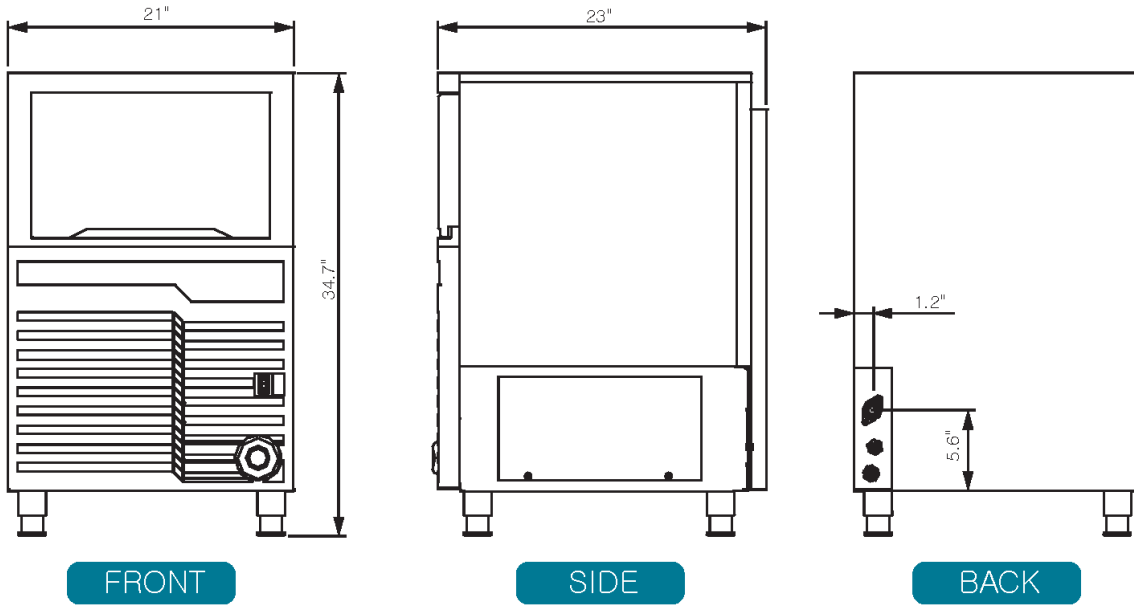

WU-0100 UNDERCOUNTER ICE MAKER

Operating Limits	Min	Max
Ambient Temperature	50°F (10°C)	100°F (38°C)
Water Temperature	50°F (10°C)	90°F (32°C)
Water Pressure	20psi(1.38bar)	80psi (5.52bar)

Dimensions	W	D	H
in	21	22.5	34.7

Weight	Lbs	Kg
WU-0100-AC	110	50

## SPECIFICATIONS

Model	Ice Shape	Ice Production Per 24 hrs		Water Usage/100 lbs of ice @ 90°F air/ 70°F water	kWH Used/ 100 lbs of ice	Electrical (V/Hz/Ph)	Circuit Breaker size (A)
		70°F Air/50°F Water 21°C Air/10°C Water	90°F Air/70°F Water 32°C Air/21°C Water				
WU-0100-AC	cube	104.72 lbs	73.63 lbs	19	10.45	115/60/1	15

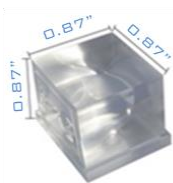

**Cube**  
7/8" x 7/8" x 7/8"  
(22 x 22 x 22mm)

